

产品特点

- 通用性强，可替代同行业类似产品；
- 专用芯片处理，抗光能力强；
- 抗电磁干扰能力强；
- 检测灵敏度高；

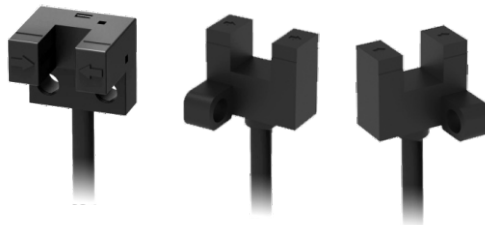

Product Features

- Wide application, can replace similar products in the same industry;
- ASIC design, Strong anti-light ability;
- strong anti-electromagnetic interference ability;
- High detection sensitivity;



额定规格/性能 Ratings and Specifications

标准型 Standard

形状 Shape						
	L型-shaped		R型-shaped		F型-shaped	
型号 Model	NPN	GE-SL951A / GE-SL951	GE-R25B-Y	GE-F25B-Y		
	PNP	GE-SL951PA / GE-SL951P	GE-R25C-Y	GE-F25C-Y		
	NPN	GE-SL951-W	—	—		
	PNP	GE-SL951P-W	—	—		
检测方式 Sensing mode	对射型 Through beam reflection					
检测距离 Sensing distance	5mm(slot width)		6mm(slot width)			
输出类型 Output type	A:NPN-NO; N/A无:NPN-NC PA:PNP-NO, P:PNP-NC, W:NO/NC		B:NPN-NO+NC; C:PNP-NO+NC			
电源电压 Power supply	5-24V DC		5-24V DC			
检测物体 Sensing material	>2×0.8mm不透明体 Opaque object		>0.8×1.8mm不透明体 Opaque object			
回路保护 Circuit protection	逆接极性保护(残留电压1.3V以下) Reverse polarity protection(residual voltage<1.3V)		电源逆接极性保护、短路保护、过载保护 Short-circuit protection,reverse connection protection,overload protection			
光源 Light source	红外发光二极管940nm Infrared emitting diode					
指示灯 Indicator light	红色指示灯 RED LED					
消费电流 Current consumption	<15mA					
控制输出 Output control	NPN/PNP集电极开路输出 DC10-24V 残留电压1.3V以下(负荷电流 80mA时) 残留电压0.4V以下(负荷电流 40mA时)		NPN/PNP 负载电源电压: DC5~24V, 负载电流: 50mA以下 漏电流: 0.5mA以下 残留电压: 1.0V以下(负载电流50mA时) 残留电压0.4V以下(负载电流5mA时)			
响应频率 Response frequency	>1KHz					
环境照明 Ambient illumination	太阳光: 10,000Lx 白炽灯: 3,000Lx Sunlight: 10,000Lx Lamplight: 3,000Lx					
环境温度 Ambient temperature	使用时: -25°C~+55°C 保存时: -30°C~+80°C, 不结冰 Work: -25°C~+55°C store:-30°C~+80°C iced forbidden					
环境湿度 Ambient humidity	使用时: 35%~85%RH 保存时: 35%~95%,不结露 Work: 35%~85%RH store: 35%~95%,dewde forbidden					
耐振动 Anti-vibration	10~55HZ,复振幅1.5mm, X,Y,Z各方向(2h) / 10~55HZ,Double-amplitude1.5mmX,Y,Z(2h)					
耐冲击 Anti-impact	500m/S <sup>2</sup> , X,Y,Z各方向3次500m/S <sup>2</sup> , X,Y,Z 3 times					
耐压 Withstand voltage	1000VAC,50/60Hz 1min 充电部整体与外壳间1000VAC,50/60Hz 1min					
防护等级 Protection degree	IEC IP67/IEC IP54		IEC IP65			
连接方式 Connection	标准导线长2米PVC-可配端子 Cable2m-PVC-terminal					
材质 Housing material	壳体 Housing: PA66					

注明:1.以上型号中体现的都是标准导线;

2.耐弯曲导线可以定制,在型号尾端部分加“R”

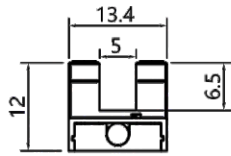

GE-SL951A  
 GE-SL951  
 GE-SL951PA  
 GE-SL951P  
 GE-SL951-W  
 GE-SL951P-W

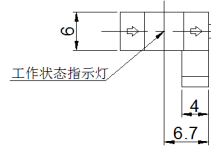
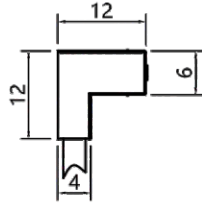
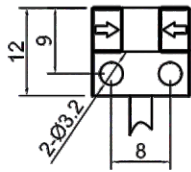

GE-F25B  
 GE-F25C

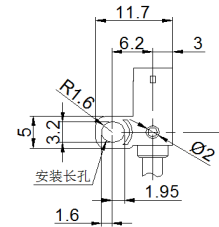
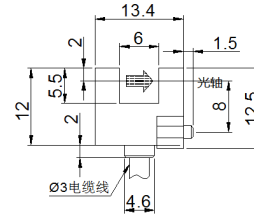

GE-R25B  
 GE-R25C

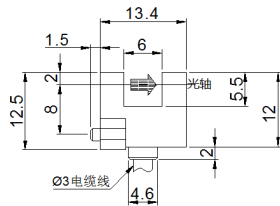
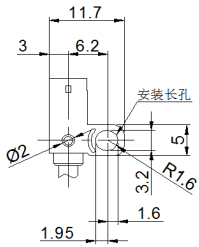
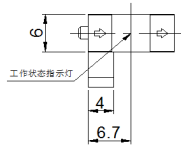

产品特点

- 通用性强,可替代同行业类似产品;
- 专用芯片处理, 抗光能力强;
- 抗电磁干扰能力强;
- 检测灵敏度高;
- 防护等级IP65;

Product Features

- Wide application, can replace similar products in the same industry;
- ASIC design, strong anti-light ability;
- Strong anti-electromagnetic interference ability;
- High detection sensitivity;
- IP65 protection grade;



额定规格/性能 Ratings and Specifications

标准型 Standard

Model(型号)	GE-Y45B-Y	GE-Y45C-Y
Sensing mode(检测方式)	对射型	
检测距离Sensing distance	6mm(槽宽)	
检测物体Sensing material	不透明体2×0.8mm以上	
电源电压Power supply	5-24V DC	
消费电流Current consumption	<15mA	
回路保护Circuit protection	电源逆接极性保护、短路保护、过载保护	
输出类型Output type	NPN-NO+NC	PNP-NO+NC
控制输出Output control	NPN 负载电源电压: DC5~24V, 负载电流: 50mA以下 漏电流: 0.5mA以下 残留电压: 1.0V以下 (负载电流50mA时) 残留电压0.4V以下 (负载电流5mA时)	PNP 负载电源电压: DC5~30V, 负载电流: 50mA以下 漏电流: 0.5mA以下 残留电压: 1.0V以下 (负载电流50mA时) 残留电压0.4V以下 (负载电流5mA时)
响应频率Response frequency	> 1KHz	
指示灯Indicator light	红色指示灯	
光源Light source	红外发光二级管940nm	
环境照明Ambient illumination	太阳光: 10000Lx 白炽光: 3000Lx	
环境温度Ambient temperature	使用时: -25°C~+55°C 保存时: -30°C~+80°C, 不结冰 Work: -25°C~+55°C store:-30°C~+80°C iced forbidden	
环境湿度Ambient humidity	动作时: 35~85%RH 保存时: 35~95%RH(不结冰、不结露)	
耐振动Anti-vibration	10-55Hz, 复振幅1.5mm X,Y,Z各向2H	
耐压Withstand voltage	1000VAC, 50/60Hz 1min充电部整体与外壳间	
防护等级Protection degree	IEC规格 IP65	
连接方式Connection	导线引出型(标配2米)	
材质Housing material	PA66	

Dimension(尺寸图) (Unit/单位:mm)		CAD数据

## 产品特点

- 通用性强,可替代同行业类似产品;
- 专用芯片处理, 抗光能力强;
- 抗电磁干扰能力强;
- 检测灵敏度高;
- 防护等级IP65;

## Product Features

- Wide application, can replace similar products in the same industry;
- ASIC design, strong anti-light ability;
- Strong anti-electromagnetic interference ability;
- High detection sensitivity;
- IP65 protection grade;

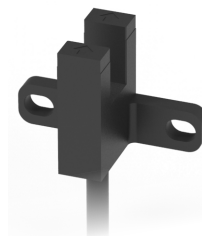

## 额定规格/性能 Ratings and Specifications

Model(型号)	GE-T45B-Y	GE-T45C-Y
Sensing mode(检测方式)	对射型	
检测距离Sensing distance	6mm(槽宽)	
检测物体Sensing material	不透明体2×0.8mm以上	
电源电压Power supply	5-24V DC	
消费电流Current consumption	<15mA	
回路保护Circuit protection	电源逆接极性保护、短路保护、过载保护	
输出类型Output type	NPN-NO+NC	PNP-NO+NC
控制输出Output control	NPN 负载电源电压: DC5~24V, 负载电流: 50mA以下 漏电流: 0.5mA以下 残留电压: 1.0V以下(负载电流50mA时) 残留电压0.4V以下(负载电流5mA时)	PNP 负载电源电压: DC5~30V, 负载电流: 50mA以下 漏电流: 0.5mA以下 残留电压: 1.0V以下(负载电流50mA时) 残留电压0.4V以下(负载电流5mA时)
响应频率Response frequency	1KHz以上(平均值3KHz)	
指示灯Indicator light	红色指示灯	
光源Light source	红外发光二极管940nm	
环境照明Ambient illumination	太阳光: 10000Lx 白炽光: 3000Lx	
环境温度Ambient temperature	使用时: -25°C~+55°C 保存时: -30°C~+80°C, 不结冰 Work: -25°C~+55°C store:-30°C~+80°C iced forbidden	
环境湿度Ambient humidity	动作时: 35~85%RH 保存时: 35~95%RH(不结冰、不结露)	
耐振动Anti-vibration	10-55Hz, 复振幅1.5mm X,Y,Z各向2H	
耐压Withstand voltage	1000VAC, 50/60Hz 1min充电部整体与外壳间	
防护等级Protection degree	IEC规格 IP65	
连接方式Connection	导线引出型(标配2米)	
材质Housing material	PA66	

CAD数据

Dimension(尺寸图)  
(Unit/单位:mm)

